

# SPECIFICATIONS

**FOUNDATION & STRUCTURE:**

RCC framed structure with ready mix concrete M 20. Earthquake Resistant with plinth beam as per HMDA standards with Termite proofing.

**SUPER STRUCTURE**

Red clay brick work in cement mortar walls of 9" thickness outer wall and 4 ½" thick inner walls.

**PLASTERING**

**INTERNAL:** Double coat cement plastering with sponge finish and luppam finish.

**EXTERNAL:** Double coat cement plastering with sponge finish.

**JOINERY WORKS**

**MAIN DOOR:** High quality Teak wood frame & shutter, polished, fixed with good quality hardware accessories.

**INTERNAL DOORS:** Good Quality Teak wood frame with flush doors.

**WINDOWS:** UPVC Windows+ mosquito mesh panel shutter using suitable sections of reputed make with safety grills and glass shutters.

**PAINTING**

**INTERNAL:** Plastic emulsion painted up to two coats for a superb finishing and look, over a luppam finish.

**EXTERNAL:** Premium quality ACE painting (Weather & Water proof)

**COMMON AREA :** Oil Bound Distemper painting done tidily.

**FLOORING**

Vitrified tiles 2' X 2'. With 4" dadoing.

**Common Area:** Granite Flooring in Corridor & Staircase with 4" dadoing.

**Parkings:** Cement Tiles or Interlocking Pavers of best quality will be provided.

**TILE CLADDING & DADOOING**

**TOILETS:** Designer glazed ceramic tile dado up to door height.

**KITCHEN:** Ceramic tile dado up to 2 feet height above kitchen platform.

**UTILITY/WASH:** Glazed ceramic tiles dado up to 2'-6" height.

Lift Entrance at all floors to be dadoed with granite to full height at all levels.

**KITCHEN PLATFORM**

Granite platform with steel sink with ground & municipal water connection provision, Exhaust Fan Provision.

**TOILETS**

E.M.C in Master bedroom with flush tank.

I.W.C for Other toilet with flush tank.

Hot and cold water mixer with shower provision for geyser in all bathrooms.

All fixers are C.P. coated best quality standard branded makes.

**ELECTRICAL**

Concealed copper wiring of standard make (ISO certified).

Switches & Plugs of standard make.

Power outlets for A/C in all bedroom.

Power outlets for Geyser in all Bathrooms

Plug points for TV. & Audio systems.

3 phase supply for each unit and individual master boards.

Miniature circuit breakers (MCB) & ELCB for each distribution board.

Power plug outlets for cooking range chimney, refrigerator, microwave oven and mixer grinder in kitchen.

**TELEPHONE & CABLE TV**

Provision for master bedroom and drawing / living room.

**LIFT**

2 Lifts of Standard make.

**GENERATOR**

Acoustic generator of Standard make.

Backup for 2 lights and 2 fans in Hall and Master Bedroom in all flats and Total common light points, and Lifts..

**SECURITY**

Solar Fenced Compound Wall.

CC Cameras Covering Parking & Common Areas.

Intercom Connecting all the flats.

## Location Map

### LOCATION HIGHLIGHTS

- ▼ Located Between Existing and Future IT Corridor of Hyderabad
- ▼ The site is under Growth Corridor (GC)
- ▼ Just 500 Mts from Outer Ring Road (ORR)
- ▼ Close to Financial District of Hyderabad
- ▼ 10 Mins Drive from Gachibowli
- ▼ 15 mins Drive from Jubilee Hills & Banjara Hills
- ▼ 20 Mins Drive from International Airport
- ▼ 7 Mins Drive to Lanco Hills
- ▼ 15 Mins Drive to Continental Hospital
- ▼ Glendale Academy : 5 Kms
- ▼ Srinidhi International School : 8 Kms
- ▼ Delhi Public School : 6 Kms
- ▼ Oakridge: 6 Kms
- ▼ Mehdiptnam 10 Kms

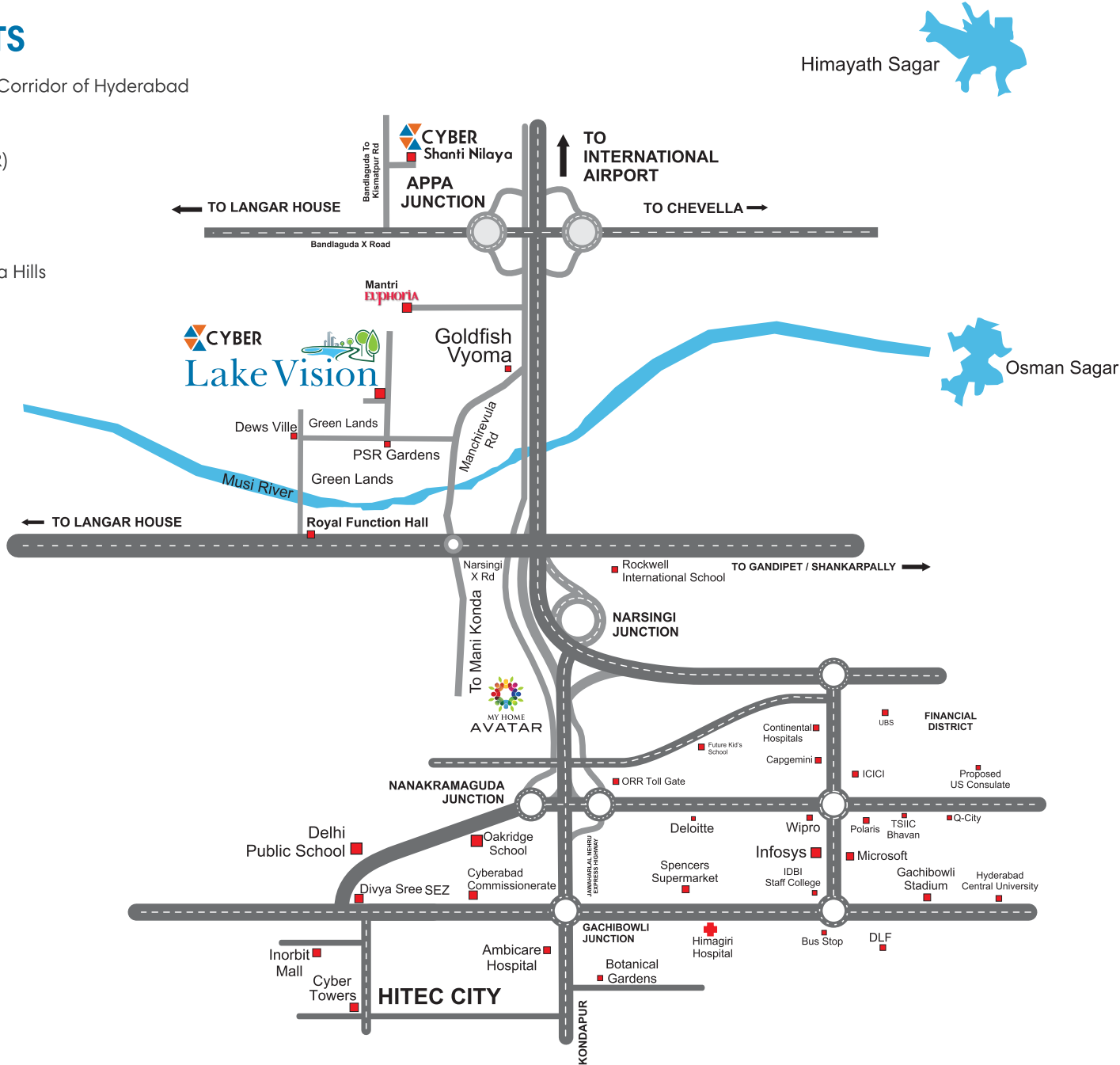

#### Site Office

Sy No: 247/P,  
Lane Opp: PSR Gardens  
Manchirevula(V)  
Rajender Nagar (M), R.R Dist.



**Corporate Office**  
Shanthi Nilaya, 9-118-14/P, 6th Floor  
Lane Opp Saraswathi Vidyapeet  
Bandlaguda (Jagir), Rajender Nagar, R.R Dist.

**www.cyberhomes.in**  
**Ph: 87900 55355 / 66 / 77**

#### ARCHITECTS



**SAAC**  
Flat No. 102, Susthira Lok  
Opp. Mahalaxmi Theatre, Kothapet, Hyderabad.  
Ph: 98666 82070, 90325 35236.

*Its all about.... Living peacefully*



CYBER HOMES  
**Lake Vision**  
@ Narsingi near Gachibowli





**Lake Vision** is perfectly placed on the Growth Corridor (GC) nearby to the outer ring road at Narsingi Junction. With upto 50 Units spanning across 2420 sq yards, The property boasts of 24/7 manned security, each individual flat equipped with Intercom facility, The location has a legitimate leverage of reaching Financial District, Kokapet within 5 kms and Gachibowli, Hitec city and major IT hubs within 10 kms. The site grants a beautiful picturesque view of the Timber lake which will bring peace to the people staying around. The property with a multipurpose hall, Top class Gym, Children's Play Area etc., will definitely give its proud owners value for their investments and also provide peaceful atmosphere with an easy accessibility to all major destinations in Hyderabad.

## TYPICAL FLOOR PLAN



## PARKING & STILT PLAN

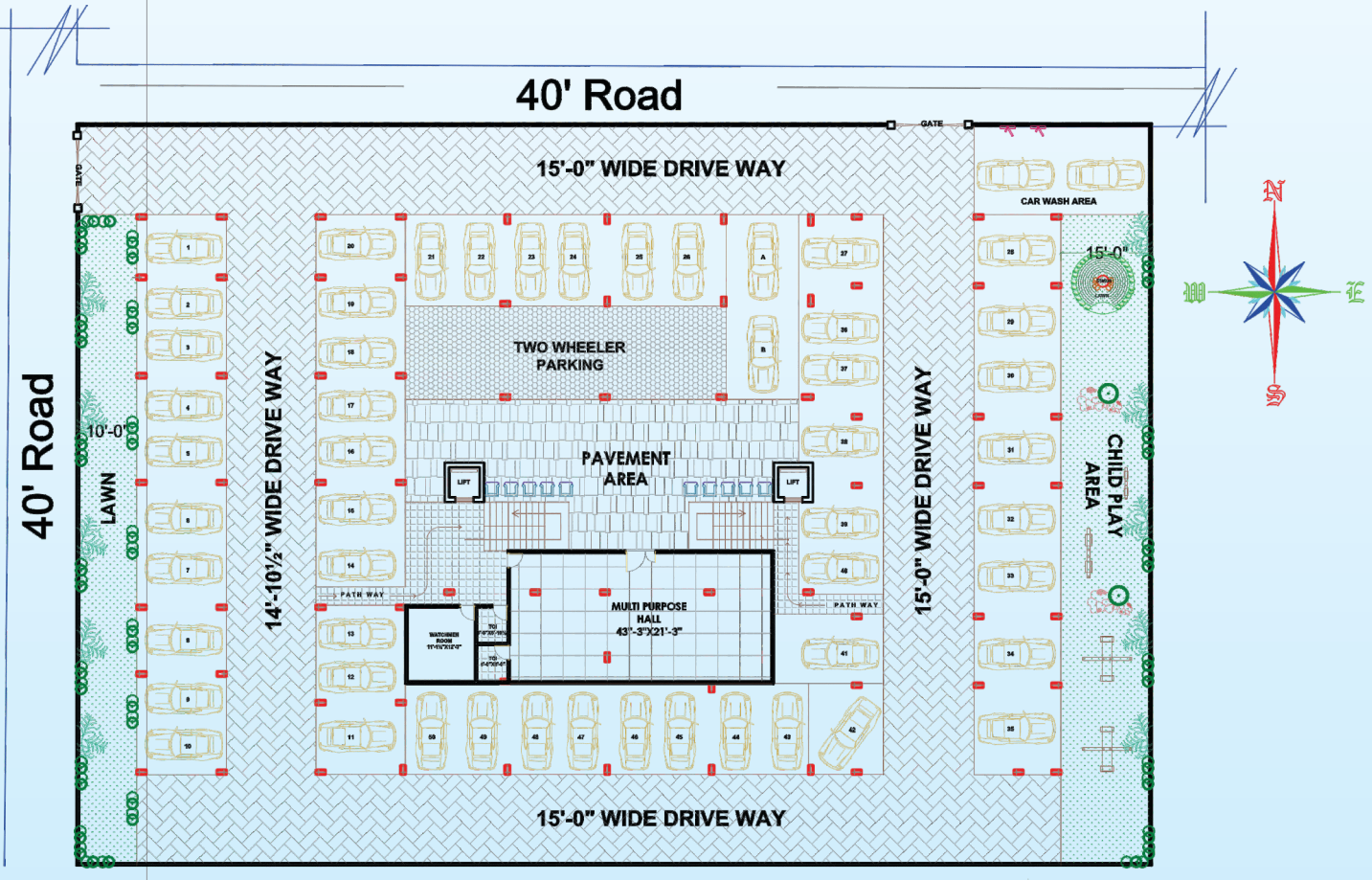

AREAS	
FLAT NO'S	TOTAL AREA (25% COMMON AREA)
FLAT 1:	1500 SFT
FLAT 2:	1360 SFT
FLAT 3:	1605 SFT
FLAT 4:	1040 SFT
FLAT 5:	1035 SFT
FLAT 6:	1145 SFT
FLAT 7:	1145 SFT
FLAT 8:	1145 SFT
FLAT 9:	1035 SFT
FLAT 10:	1040 SFT

## PROJECT HIGHLIGHTS

- 100% Vastu Compliant
- North-West Corner Apartment, 40 Feet Road both sides
- Children's Play Area
- Gym • Banquet Hall • Car Wash Area
- Power Backup • Complete Ground Level Parking
- Rain Water Harvesting System
- 2 BHK and 3 BHK Apartments (35 - 2 BHK and 15 - 3 BHK)
- No Common Walls
- Solar Fenced Compound Wall

